

SHIMANO

CAIUS

CIS151HGB

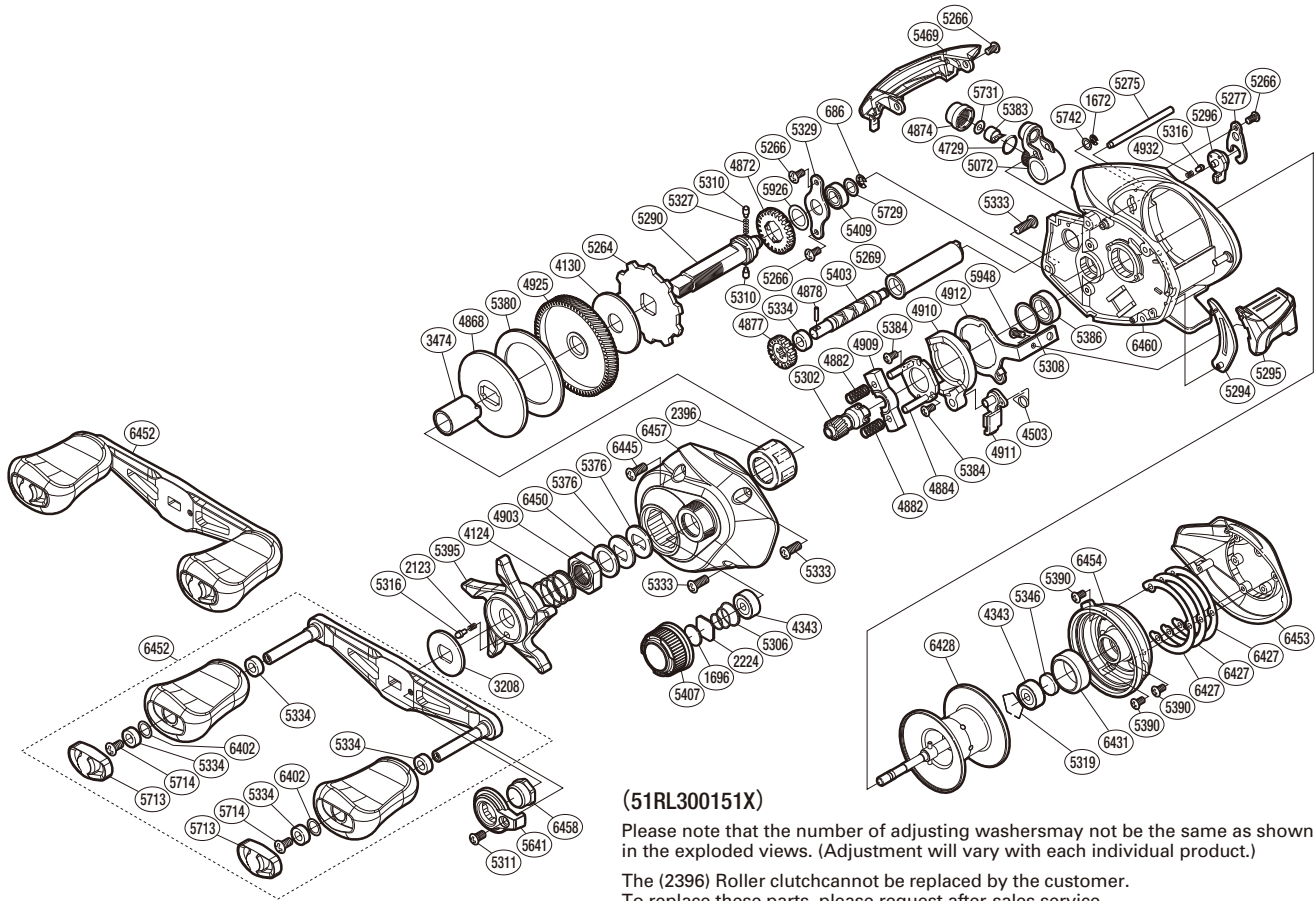

(51RL300151X)

Please note that the number of adjusting washers may not be the same as shown in the exploded views. (Adjustment will vary with each individual product.)

The (2396) Roller clutch cannot be replaced by the customer. To replace these parts, please request after-sales service.

Part No.	Description	Part No.	Description	Part No.	Description
BNT0686	E Lock	BNT5072	Line Guide Pawl Holder Assembly	BNT5390	Screw
BNT1672	E Lock	BNT5264	Anti-Reverse Ratchet	BNT5395	Star Drag
BNT1696	Cast Control Spacer (B)	BNT5266	Screw	BNT5403	Worm Shaft
BNT2123	Click Spring	BNT5269	Level Wind Guard	BNT5407	Cast Control Cap
BNT2224	Cast Control Spacer (A)	BNT5275	Stabilizer Bar	BNT5409	Drive Shaft Bushing
BNT2396	Roller Clutch Bearing	BNT5277	Cam Lever Retainer	BNT5469	Level Wind Protector
BNT3208	Star Drag Click Plate	BNT5290	Drive Shaft	BNT5641	Handle Nut Plate
BNT3474	Roller Clutch Inner Tube	BNT5294	Clutch Bar Guide B	BNT5713	Handle Knob Seal
BNT4124	Star Drag Spring	BNT5295	Clutch Button	BNT5714	Screw
BNT4130	Drag Washer A	BNT5296	B Side Plate Cam Lever	BNT5729	Washer
BNT4343	Ball Bearing	BNT5302	Pinion Gear	BNT5731	Washer
BNT4503	Clutch Pawl Spring	BNT5306	Spool Tension Spring	BNT5742	Washer
BNT4729	O Ring	BNT5308	Washer	BNT5926	Washer
BNT4868	Key Washer	BNT5310	Idle Gear Pin	BNT5948	Screw
BNT4872	Idle Gear A	BNT5311	Screw	BNT6402	Washer
BNT4874	Pawl Cap	BNT5316	Click Pin	BNT6427	Washer
BNT4877	Idle Gear C	BNT5319	Bearing Retainer	BNT6428	Spool Assembly
BNT4878	Worm Shaft Pin	BNT5327	Idle Gear Spring	BNT6431	Brake Ring
BNT4882	Yoke Spring	BNT5329	Drive Shaft Retainer	BNT6445	Screw
BNT4884	Clutch Cam Retainer	BNT5333	Screw	BNT6450	Star Drag Spacer
BNT4903	Star Drag Nut	BNT5334	Handle Knob Bushing B	BNT6452	Handle Assembly
BNT4909	Yoke	BNT5346	Bearing Spacer	BNT6453	Right Side Plate
BNT4910	Clutch Cam	BNT5376	Drag Spring Washer	BNT6454	Dial Case
BNT4911	Clutch Pawl Assembly	BNT5380	Drag Washer C	BNT6457	Left Side Plate
BNT4912	Clutch Plate	BNT5383	Line Guide Pawl	BNT6458	Handle Nut
BNT4925	Drive Gear	BNT5384	Screw	BNT6460	Frame Assembly
BNT4932	Click Spring	BNT5386	Ball Bearing		